



ROTARY DRUM MOWER

USER GUIDE



HT ALPLER

ATTENTION



**DO NOT
OPERATE THE MACHINES
BEFORE READING THIS MANUAL!**

INDEX

1. INTRODUCTION	3
2. SAFETY RULES	4-5
2.1. GENERAL SAFETY INFORMATION	4
2.2. SAFETY TRAINING	5
2.3. WORKING SAFETY	5
3. SETTINGS	6-10
3.1. INTRODUCING THE MACHINE	6
3.2. TRANSPORTING	7
3.3. INTRODUCTION	8
3.4. PREPARING THE MACHINE FOR WORK	9-12
4. MAINTENANCE AND REPAIR	13-14
4.1. MAINTENANCE PERIODS	14
5. WARRANTY	15

WARNING SIGNS & MEANINGS



CAUTION

This sign warns that the operations described could cause damage to machine, if they are not carried out correctly.



READ MANUAL FIRST

Read the "Operating and Maintenance Manual" carefully before first start and keep the manual nearest.



WARNING

This sign warns that the operations described could cause serious lesions or long term health risks, if they are not carried out correctly.



KEEP CHILDREN AWAY

This symbol expresses to keep the children away against any risk.



Be careful against danger of entrapment.



DO NOT STAND NEAR THE MACHINE WHILE IT IS WORKING

This symbol expresses not to stand near the machine while it is working to avoid any injury.



Do not carry people or loads on the plough.



REVOLVING DEVICE

Stay clear of mower knife area as long as tractor engine is running



Do not open or remove safety shields while the engine is running



Shut off engine and remove key before performing maintenance or repair work.

1. INTRODUCTION

Dear Farmer,

Firstly, we congratulate you for your correct preference on the way to efficiency by selecting the brand "ALPLER". As your agricultural partner, we offer you our product in which we combined high quality, low operational cost and effective after-sale service concept.

All of "ALPLER" products are designed for the most efficient and the safest use and tested accordingly in cooperation with the relevant university departments, agricultural establishments and farmers. We request you to read the user manual before the first operation in order to use our product in a more effective manner as well as for product and your own safety. The failures that may result from using the product beyond the instructions for use specified in this manual are not covered by "ALPLER" warranty. "ALPLER" products are manufactured for agricultural utilization purposes only, and our company does not assume any liability against the conditions arising from misuse. Maintenance, repair and operation of our products must be carried out by those who were informed on the relevant and possible dangers.

Enjoy your new product and we wish you productive and fruitful years.

We hope to serve you for a long time...



CAUTION

If the product owner changes in the future, please submit this manual to the new owner of the product and inform on safety measures.

2. SAFETY RULES

2.1. GENERAL SAFETY INFORMATION

Note the use of the signal words Danger, Warning and Caution with the Safety messages.

The appropriate signal word each has been selected using the following guidelines:



DANGER!

Indicates an imminently hazardous situation that, if not avoided, will result in death or serious injury. This signal word is to be limited to the most extreme situations typically for machine components, which, for functional purposes, cannot be guarded.



WARNING

Indicates a potentially hazardous situation that, if not avoided, could result in death or serious injury, and includes hazards that are exposed when guards are removed. It may also be used to alert against unsafe practices.



CAUTION

Indicates a potentially hazardous situation that, if not avoided, may result in minor or moderate injury. It may also be used to alert against unsafe practices.

Safety of the operator is one of the main concerns when designing and developing a new piece of equipment. You, the operator, can avoid many accidents by observing the following precautions in this section.

- Replace any **CAUTION, WARNING, DANGER** or instruction safety decal that is not readable or is missing.
- Do not attempt to operate this equipment under the influence of drugs or alcohol.
- Review the safety instructions with all users.

This equipment is dangerous to children and persons unfamiliar with its operation. The operator should be a responsible adult familiar with the equipment and its operation. Do not allow persons to operate this unit until they have developed understanding of the safety precautions and of how it works.

2. SAFETY RULES

- To prevent injury or death, use a tractor equipped with a Roll Over Protective System (POPS). Do not paint over, remove or deface any safety signs or warning decals on your equipment, Observe all safety signs and practice instructions on them.
- Never exceed the limits of a piece of machinery. If its ability to do a job, or to do so safely, is in question – Don't try it.
- Remember - Your best assurance against accidents is a careful and responsible operator. If there is any portion of this manual or function you do not understand, contact your local dealer or manufacturer.
- If you have questions not answered in this manual or require additional copies or the manual is damaged, please contact your dealer or ALPLER company.

2.2. SAFETY TRAINING

All machines have stickers glued on. In this stickers machine type, address of manufacturer, machine serial number, model of the machine is prescribed.

- Make sure you get familiar with all devices and elements for handling and with the functions before starting with the work.
- Avoid wearing loose-fitting clothes.
- Clothes should fit tight to the operators body.
- Implements should be connected according to the instructions, fastened to the prescribed devices and secured.
- Never left the driving seat during driving.
- Starting devices for remote control should be secured in a way that, they can not be unintentionally released during transport or work.
- When disconnecting the machine from the tractor, place it on the flat ground.
- Never jump, sit or climb on the machine while it is connected to the tractor.
- Stopping or operating the machine must be done by the driver.
- No one may drive the tractor except the driver.
- Use protection for hearing and glasses while working with the machine if the tractor does not have a closed cabin.

2.3. WORKING SAFETY



ATTENTION!

Rear operators manual before starting to work with the machine

Safety Decals:

There are three types of main safety decals. These are shown as,

Danger:

When you see this alert symbol and heading be alert to the danger of injury or death of men and animals.

Alert:

When you see this heading, be alert to the possibility of serious injuries because of using the machine out of the using rules.

Attention:

When you see this heading, be alert to the possibility of damage to equipment, crop, building, etc. But to financial and / or juridical problems as well.

3. SETTINGS

3.1. INTRODUCING THE MACHINE

Rotary Drum Mower has been designed from mowing of all kinds of grass and clover on clean surfaces. It consists of a cutter with 2 drums, where each of them is equipped with three knives. Drums are turnably fastened to the cutter-bar housing. Protection covers covering the cutter bar from the top, are also fastened to the cutter bar housing. The cutter bar is surrounded by protection curtain. Three point hitch for connection to the tractors of the I or II category is made of round tube. Mower drive is led from the tractor over the P.T.O. Shaft to the connecting shaft of the mower, belt transmission, gear-box transmission shaft to the gears in the gear-box and over them to the drums. Mower is equipped with a safety fuse which protects it from damages which may occur if the mower hits an obstacle.

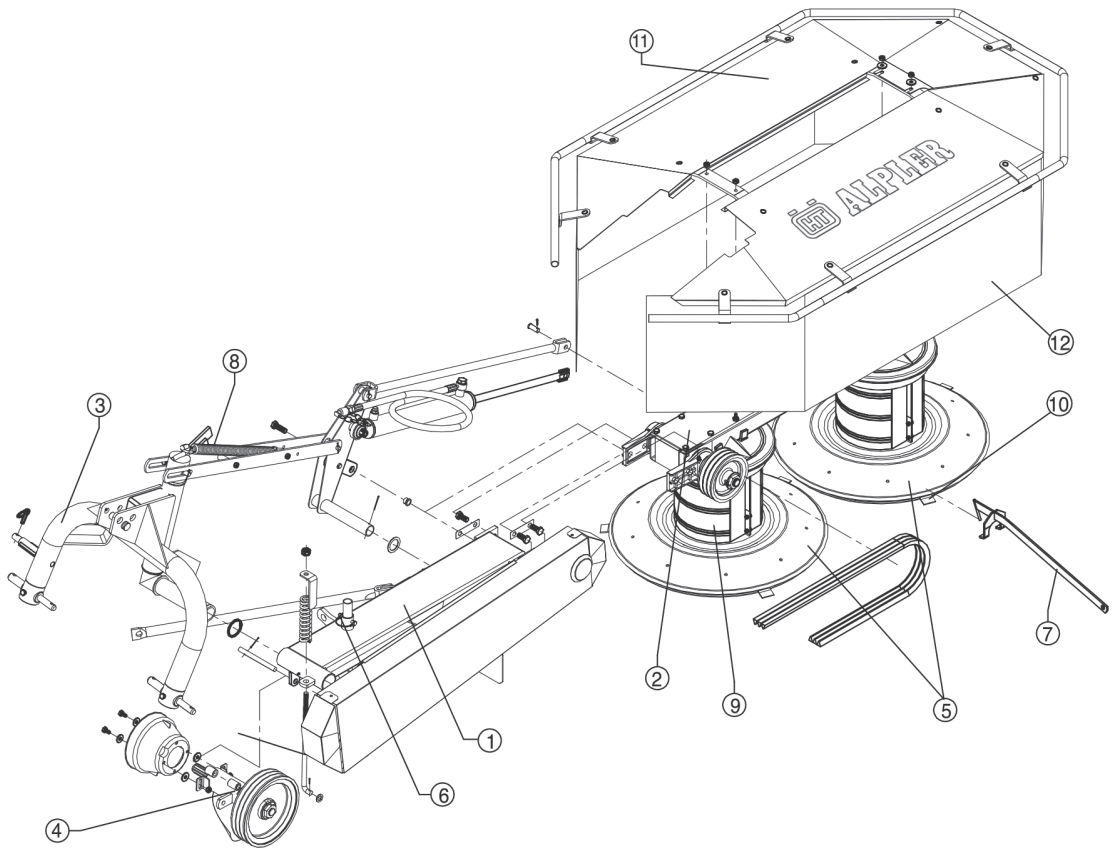

- 1. Main Holder
- 2. Cutter-bar (gear box)
- 3. Three point hitch system
- 4. Belt drive
- 5. Drums
- 6. Support Leg

- 7. Knife holder
- 8. Strecher spring
- 9. Upper disc
- 10. Knife
- 11. Protection plate
- 12. Curtain

3. SETTINGS

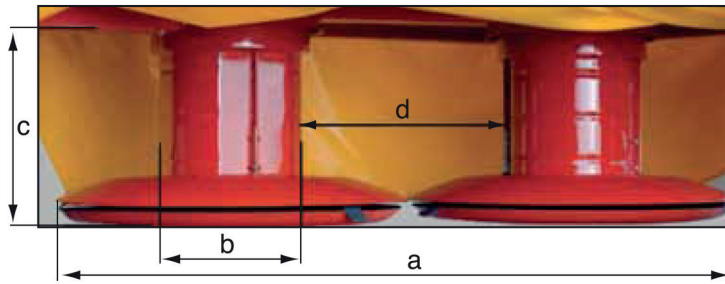

Figure 1 - Dimensions of Rotary Drum Mower

Alpler offers you the Rotary Drum Mower which is driven by the tractor tail spindle and connected to it with three point hitch system. It reaps, the feet plants, grass, meadow grass as well as wild plants and heath bordering the roads. It achieves high capacity with low power consumption and provides propellant saving. The action is transmitted serially through its three fault belt pooley. The belt of the pooley mechanism is tightened with a spring. It has an automatic security system. Reaping height can be adjusted. Adjustment is possible for road and work status. Besides the instructions from this book taken to consideration all generally used safety and accident regulations before working with the machine.



ATTENTION!

While the machine is connected to the tractor and if the tractor is in working position.

3.2. TRANSPORTING

Never carry anyone or any animal on the machine.

Pay attention on the traffic rules on public roads.

Check out the lightening, warning decals, and protection guards before starting to work.

Pay attention to work with the machine in the daylight. Especially at nights in public roads take care to have safety decal (light decal apparatus) on the machine.

Transporting the machine

1. Transporting with forklift:

You must choose a forklift according to the weight of the machine. Hold the machine from its weight center. Connect the forklift hook on the machine from the weight center. Start transporting the machine.

2. Transporting with crane:

This method is same as transporting with forklift. Hold the machine from its weight center by crane. Pay attention if the security lock of the crane's hook is working safely.

3. Transporting with palette:

Choose palette according to the machine dimensions. Transport the machine by forklift while it is on palette.

3. SETTINGS

3.3. INTRODUCTION



ATTENTION!

Pay attention to be not under the machine while transporting

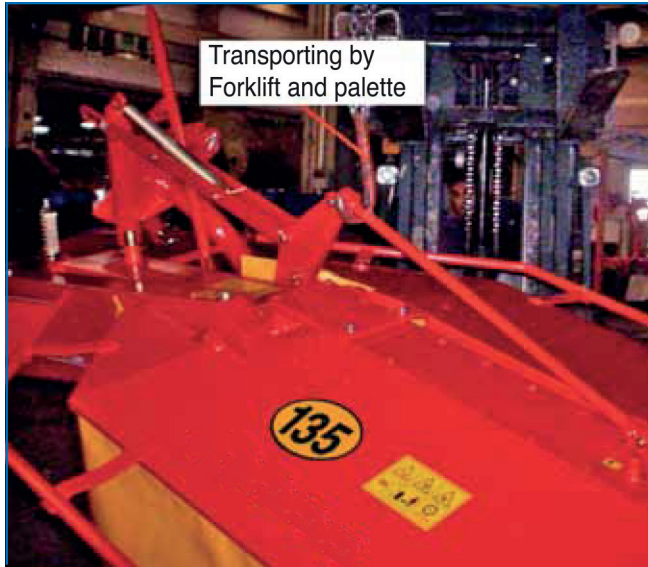

Figure 2 - Transporting the machine by Forklift and Palette



ATTENTION!

Take care of the hooks and iron ropes of the crane and forklift to be safety enough.



3. SETTINGS

3.4. PREPARING THE MACHINE FOR WORK

Required Tractor Equipment;

- Mower may only be driven by a tractor shaft with max. 540 rpm.
- Three point connecting bars of the I or II category

Connecting to the Tractor;

Firstly connect the lower non adjustable arm then adjustable arm at the end connect upper connection arm. While disconnecting the machine do the opposite. The machine should be positioned as near to the tractor as possible, for using the whole working width (Figure 4)

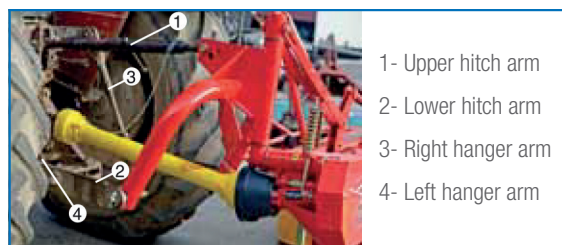

Figure 4 - Connection to the tractor

- The main holder on the machine can be connected to the three point hitch system while the tractor is parallel to the ground as shown in the (Figure 4).
- Connect the prescribed P.T.O shaft and secure the P.T.O shaft connection by a chain (Figure 4).
- Make sure that the P.T.O shaft is in proper position on both ends.
- If the load in front wheels is not enough put additional load.

Adjustment of the P.T.O Shaft;

The adjustment of the P.T.O shaft is necessary for different tractors. To find out the right length.

- Connect the machine to the tractor
- Pull out the P.T.O shaft entirely and connect each separate half of the shaft to the tractor and then compare them with each other.
- In case you need to shorten the P.T.O shaft, make sure you shorten both shafts and protection tubes for exactly the same length.



Figure 5 - Adjusting the length of the P.T.O shaft to the proper dimension for the tractor

- File the end of the tube, remove the remainings of filling and lubricate gliding spots well.
- KT4 101 910 100 (covered, triangle piped 400 serial, machine side 1 3/8 Z6, tractor side 1 3/8 Z6-1000 mm. length) shaft is used in Rotary Drum Mower.
- P.T.O shaft can only be connected when the P.T.O connection and engine are switched off and the ignition key is pulled down.

3. SETTINGS

Preparation of the mower for transport position;

If the machine is connected to the tractor and the machine is in transport position, take the P.T.O shaft in safety by the chain. In working position connect the P.T.O shaft to the tractor.



Figure 6 - Transport position



Figure 7 - Disconnect the tension spring (1)

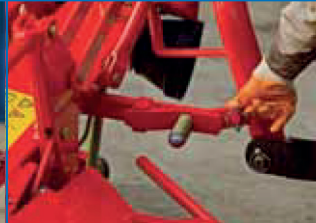

Figure 8 - Connect the tension pin and control (2)



Figure 9 - Lowering of the Mower from the transport into the working position (3)

In working position connect the P.T.O shaft to the tractor



Protection chain



Figure 10 - Lowering of the Mower from the transport into the working position

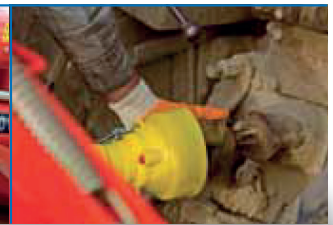

Regulation of cutting height

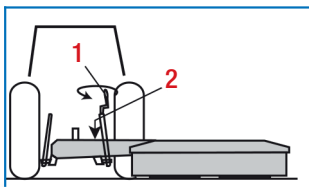

Figure 11
Regulation of cutting height

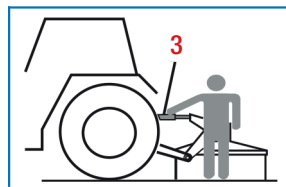

Figure 12
Fastening of tractor bottom arm

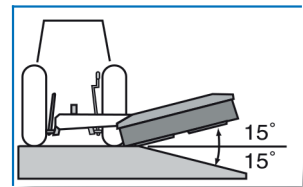

Figure 13
Working angle of the machine to the ground

- The machine must be in horizontal position when it is connected to the tractor (2) (Figure 11).
- By turning the tractor upper arm regulate the cutting height (1) (Figure 11).
- Fasten the tractor bottom arm, so you can prevent the vibrations on the machine while it is working (3) (Figure 12).

For a regular cutting, the cutting unit of the machine should not be higher or lower from the ground.

3. SETTINGS



ATTENTION!

NEVER TOUCH THE MACHINE WITH HAND, FOOT WHILE IT IS WORKING

Replacement of the protection curtain:

- Untighten the screws for fastening the protection curtain.
- Pull the curtain out of the notch.
- Install new curtain and fasten it by screws.

Protection of the Mower:

Drum Mower is equipped with a safety fuse, which gets released when the mower hits an obstacle. Mower moves backwards. In this case stop immediately and pull backwards so that the safety fuse will get contact again. Do not forget to remove the obstacle before starting to move again. The safety fuse does function when driving backwards. In case the safety fuse is released too fast at normal working, adjust it by a nut (Figure 14).

Belt tightening:

The vee-belts are mostly stretched in the first working hours. On the tightening device there is a spring that enables the belts to remain tightened in spite of the stretching. We advise you to control the level of tightening from time to time (Figure 14).

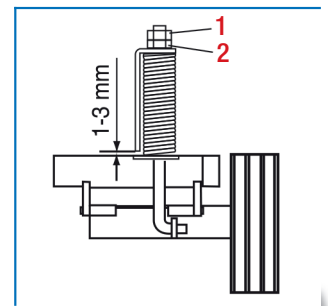

Figure 14
Belt tightening working with
Drum Mower

Attention:

- If you tighten the belts more than necessary, there is a danger of damaging the bearings and shaft.
- Pay your best attention to proper mounting and securing of the P.T.O shaft.



ATTENTION!

Max. Input rotation speed of the machine is 540 rpm.

3. SETTINGS



ATTENTION!

Stop the engine! Then adjust and prepare the machine for work

- Make sure that nobody is in the area of danger of the implement before switching on the P.T.O shaft connection.
- When working with the P.T.O shaft connection nobody is allowed to be in the area of rotating connection on the P.T.O shaft.
- After switching off the P.T.O shaft connection the danger of rotating heavier parts remains. Do not get close to the implement during this period. You can start to work only when the rotation is completely stopped.
- P.T.O shaft protection must be fitted on. And must be in perfect condition.
- Use only original P.T.O shafts prescribed by your manufacturer. Because the manufacturer will not take any responsibility if another shaft is used.

Transporting the machine to the field to prepare for work:

- Start the engine of the tractor for a minute. Hold the machine with main hydraulic arm. Attach the security lock for not to damage to the hydraulic system while driving. Stretch the stretching chains to prevent swinging. Transport the machine empty (without fertilizer) to the field. Fill the fertilizer to the tank in the field.
- In transporting position, raise the machine up and lock the security pin to prevent the machine fall down.
- In turnings, take into consideration the load which is outside the centre of gravity and/or constant weight of the implement.
- Working with tractor in the tendency fields can give damage to the machine. But if you have to work in these tendency fields take care of working, do not turn the road bend fastly and sharply. For working in tendency fields you must be careful about if the tractor is decked out with the additional weights.

4. MAINTENANCE AND REPAIR



ATTENTION!

Maintenance, repairs, cleaning may only be executed when the drive and the engine are switched off and the ignition key is pulled out.

Drum Mower is produced by full of quality. So this machine will not need so much maintenance and repair after working with the machine.

Take care about the items that is written below for maintenance and repair:

- Turn engine off when adjustment, service and repair work is to be done.
- Do not work under the machine without safe support.
- Retighten all screws after the first hours of operation.

Cleaning of machine parts:

- Do not use high pressure water for the cleaning of bearing and hydraulic parts (Figure 15).
- Danger of rust.
- After cleaning, grease the machine according to the lubrication chart and carry out a short test run.
- The knife has cutting edges at both sides. Therefore it is possible as soon as one edge is blunt to take the knives and use it on the next drum (Figure 16).

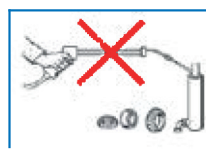

Figure 15
Cleaning of machine parts

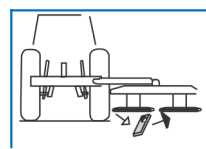

Figure 16
Wearing of the knives

Replacing the knives:



Figure 17
Replacing the knives

- Check the weariness of the knives more frequently on stony ground.
- Check normally every 100 hours.
- Check the mowing blade mountings more frequently when mowing on stony ground.

If mowing disc is worn through close to the mowing knives proceed as follows:

- Remove bottom disc.
- Undo nuts on knife mountings.
- Tighten bolts firmly and check aftersome hours operation.

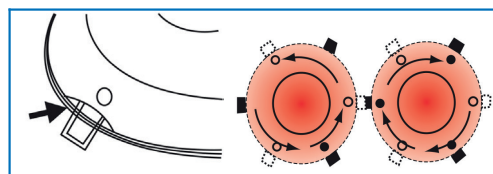

Figure 18
Changing of worn bottom disc

4. MAINTENANCE AND REPAIR

4.1. MAINTENANCE PERIODS

CONTROL (A)	MAINTENANCE (B)			VARIATION (C)	
Maintenance Period	Daily	Weekly	30 Hours	100 Hours	400 Hours
Lubrication (Level control of gear box oil) Variation of oil (BR000)			A		C
Oil leakage control	A				
Wearness control of drums	A				
Lubrication grease nipples		B			
Tightness controll (bolt-nut)	A				
Cleaning	B				

Lubrication:

- Lubricate with grease before starting work and every 8 hours worked.
- Before any extended period of non-use, clean and lubricate drive shafts.
- For winter working, grease the tube guards, to avoid them freezing together.
- Gear oils according to operating instructions-however at least once a year.
- Take out oil drain plug, let run out and duly dispose waste oil.
- Before garaging the machine (winter seaseon) an oil change and greasing of all lubricating points has to be done. Unprotected metal parts outside (joints e.t.c.) have to be protected against corrosion.

The oil in the gear-box is 15-16 kg.

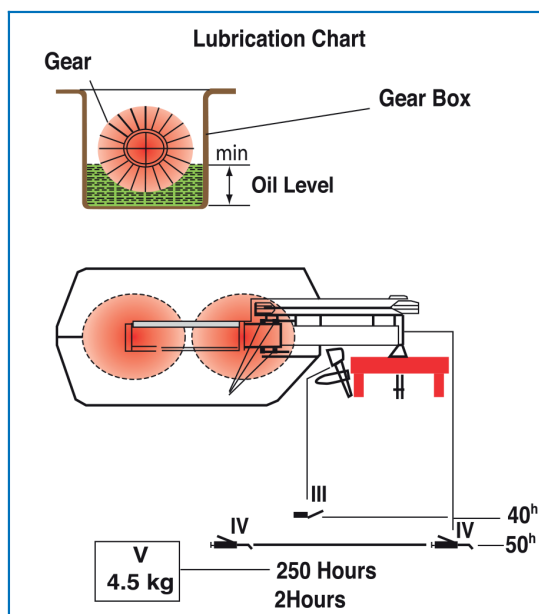
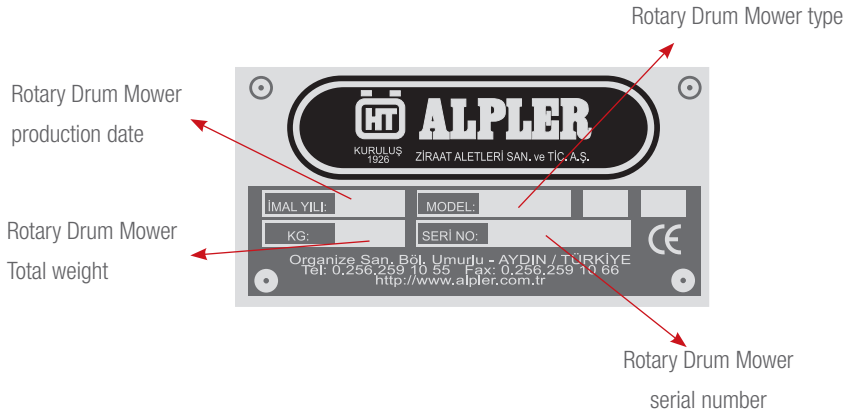

Figure 19
Lubrication chart

5. WARRANTY



Use original spare parts in ALPLER branded products. The customer will be responsible for the problems that occur due to not using original spare parts. The Rotary Drum Mower will not be covered by the warranty when non-original parts are installed on the Rotary Drum Mower, additional equipment is attached on the Rotary Drum Mower or it is used after removing standard parts.

While ordering spare parts, for the codes beginning with 'O', machine serial number together with the part code should be provided. For other codes, it is not necessary to provide the Rotary Drum Mower serial number.

Label information is important for identifying the Rotary Drum Mower and for spare part orders. As a measure against the illegibility of the label due to deformation or its loss, label information on the Rotary Drum Mower should be written literally in the corresponding fields of the following label picture, and it should be retained.

Our Rotary Drum Mowers are **warranted for 2 years** for faults that may occur due to material, workmanship and mounting errors.

Faults resulting from improper use are not covered by the warranty. The average lifetime is 10 years.



Exports to 75 countries
on 5 continents.

HT ALPLER



Manufacturer: Alpler Agricultural Machinery Organize Sanayi Bölgesi, Umurlu - AYDIN / TURKEY

UK Quarter: Units 2, Poplars Farm Forshaw Heath Road, Earlswood Solihull, B94 5JX / UNITED KINGDOM



+44 121 740 0194



info@alpler.uk



www.alpler.uk