

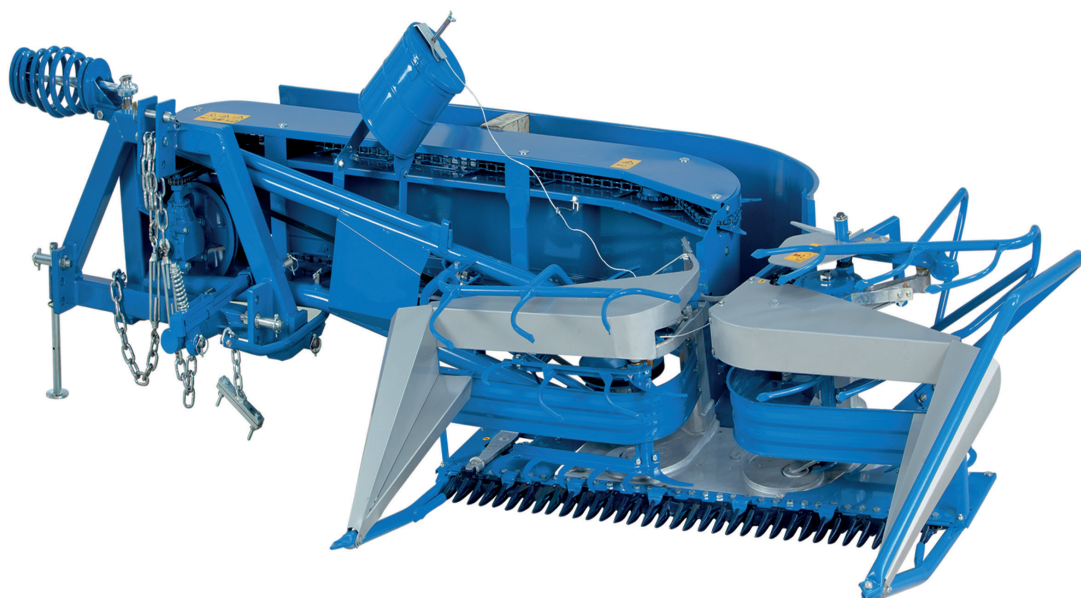

REAPER BINDER

USER GUIDE



HT ALPLER

ATTENTION



**DO NOT
OPERATE THE MACHINES
BEFORE READING THIS MANUAL!**

INDEX

1. INTRODUCTION	3
2. SAFETY RULES	4
2.1 WORK SAFETY	4
3. GENERAL INFORMATION	5
3.1 EAPER-BINDER REAPING MACHINE	5
4. INTRODUCTION OF THE MACHINE	6
5. SETTINGS	7
5.1 PREPARATION AND OPERATION OF MACHINE	7
6. MAINTENANCE AND REPAIR	10
7. WARRANTY	12

WARNING SIGNS & MEANINGS



READ MANUAL FIRST

Read the "Operating and Maintenance Manual" carefully before first start and keep the manual nearest.



KEEP CHILDREN AWAY

This symbol expresses to keep the children away against any risk.



CAUTION

This sign warns that the operations described could cause damage to machine, if they are not carried out correctly.



Keep away at a safe distance.



WARNING

This sign warns that the operations described could cause serious lesions or long term health risks, if they are not carried out correctly.



Be careful against danger of entrapment.



Do not open or remove safety shields while the engine is running

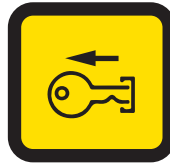

Stop the motor before maintenance or repair, and remove the contact key.



Keep away from the PTO joint area while the motor is running.



For best technical service, please refer to the technical handbook



Wait for the machinery parts to stop completely before touching.



Keep away from the draw connection lifting mechanism while the movement transition spindles are working.

1. INTRODUCTION

Dear Farmer,

Firstly, we congratulate you for your correct preference on the way to efficiency by selecting the brand “ALPLER”. As your agricultural partner, we offer you our product in which we combined high quality, low operational cost and effective after-sale service concept.

All of “ALPLER” products are designed for the most efficient and the safest use and tested accordingly in cooperation with the relevant university departments, agricultural establishments and farmers. We request you to read the user manual before the first operation in order to use our product in a more effective manner as well as for product and your own safety. The failures that may result from using the product beyond the instructions for use specified in this manual are not covered by “ALPLER” warranty.

“ALPLER” products are manufactured for agricultural utilisation purposes only, and our company does not assume any liability against the conditions arising from misuse. Maintenance, repair and operation of our products must be carried out by those who were informed on the relevant and possible dangers.

Enjoy your new product and we wish you productive and fruitful years.

We hope to serve you for a long time...

CAUTION

If the product owner changes in the future, please submit this manual to the new owner of the product and inform on safety measures.



2. SAFETY RULES

2.1 WORK SAFETY

Security Labels: There are three types of danger labels.

Danger: Importance of safety labels: they should be on the machine in order to prevent serious injuries, deaths and long-term life risks that may arise due to misuse of the machine.

Warning: Importance of warning labels:

Attention: Importance of attention labels: they indicate that the risks that may give harm to machines due to misuse of the machine should be paid attention to.



READ THE USER'S MANUAL PROVIDED BY THE MANUFACTURER COMPANY

Labels identifying the machine should be available on each machine. Information such as machine type, address of the manufacturer, machine model, serial number, year of manufacture and standard weight of the machine should be available on these labels.

- Pay attention also to applicable safety and accident prevention rules of professional chambers besides explanations available in user's manuals related to the machine
- Do not stand in the turning area of the machine. Crush hazard.
- Do not interfere the machine by hand, foot and foreign substances while the REAPER-BINDER REAPING Machine is running.
- Do not place your arm and foot between the machine and the tractor or do not hold the machine during operation. (Crush hazard)
- The machine shall continue to work for a little more even if the engine is stopped. Make sure that the machine is completely stopped.
- Keep the distance between yourself and the machine. The machine may throw parts as stone during operation. Take precautions.
- Stop the engine, make sure that it shall not start while working on the machine.
- Above warning and explanatory plates (labels) present important explanations with regards to non-hazardous operation. Compliance with these labels shall serve for your own safety. Immediately renew the damaged warnings and explanatory plates.
- Do not let anyone stand between the machine and tractor during operation. Make sure that the machine is secured against sliding by means of a braking mechanism or skid.
- Make sure that the clothes on the machine operator are tight. Baggy clothes should be avoided.
- Keep the machine clean against fire hazard.
- Mount the machine in compliance with the rules and connect only to mechanisms set forth.
- Never leave the driver's seat during movement.
- Crushing and cutting points shall occur in units operated by cutter parts or spring power. Pay attention to these points.
- Place the machine on the ground before leaving the tractor, stop the engine and remove the ignition key.
- Get on and off the tractor when the hydraulic system is off.
- Keep the foreign substances that may damage the machine away from operation field of machine.
- Adjust the operation speed of your machine based on the working conditions and status of the field to be worked in.
- Do not climb over the machine while mounted on the tractor.
- REAPER-BONDER REAPING Machine should be turned on and off only by the driver of the tractor.
- In case the tractor on which the machine is mounted on does not have a closed driver cabinet, please use a noise protector and goggles during operation.

3. GENERAL INFORMATION

3.1 REAPER-BINDER REAPING MACHINE

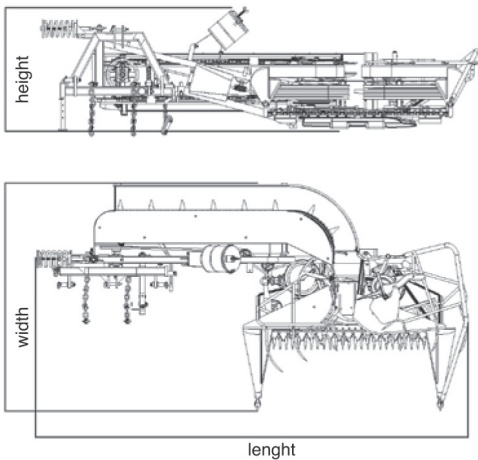

Figure 1 / Dimensions of Machine

ALPLER Reaper-Binder is a power take-off driven reaping and binding machine carried by a tractor.

Please read the user's manual carefully before operating the machine and pay attention to explanations and warnings given in order to use it in compliance with the rules and purpose.

W (width) 2320 mm

L (length) 3250 mm

H (height) 900 mm



ATTENTION!

While the tractor is moving with the machine mounted on the tractor

- Do not carry animals or human on the machine.
- Comply with the relevant traffic rules on the roads open to traffic.
- Check and mount the handling lightening, warning systems and also protection systems.
- Operations with reaper-binder machine should be performed under sufficient daylight and traffic rules should be complied with on roads open to traffic. The machine should be enlightened in compliance with the traffic rules particularly at nights. We suggest reflector enlightening.

Handling of machine from one place to another:

1. Handling with Forklift : Choose a forklift appropriate for the weight of machine. Lift the machine from centre of gravity. Insert the forklift hook in the part on the machine made for handling purposes and handle the machine.
2. Handling with Crane: It is the same with the method of handling with forklift. Insert the crane hook into the part located at the centre of gravity of the machine and handle the machine. Make sure that the crane hook lock is functioning.
3. Handling by means of Pallet: Chose a pallet appropriate for the size of machine. Handle the machine by means of a forklift while over a pallet.



Figure 2 / Handling of machine from one place to another



ATTENTION!

DO NOT GET UNDER THE MACHINE DURING HANDLING!

- Do not let anyone under or close to the machine at the area in which handling with crane, forklift or pallet is made.
- Make sure that the hooks and ropes used during handling are safe and sound.



ATTENTION!

MAKE SURE THAT THE HOOKS AND ROPES OF CRANE AND FORKLIFT USED DURING HANDLING ARE SAFE!

4. INTRODUCTION OF THE MACHINE

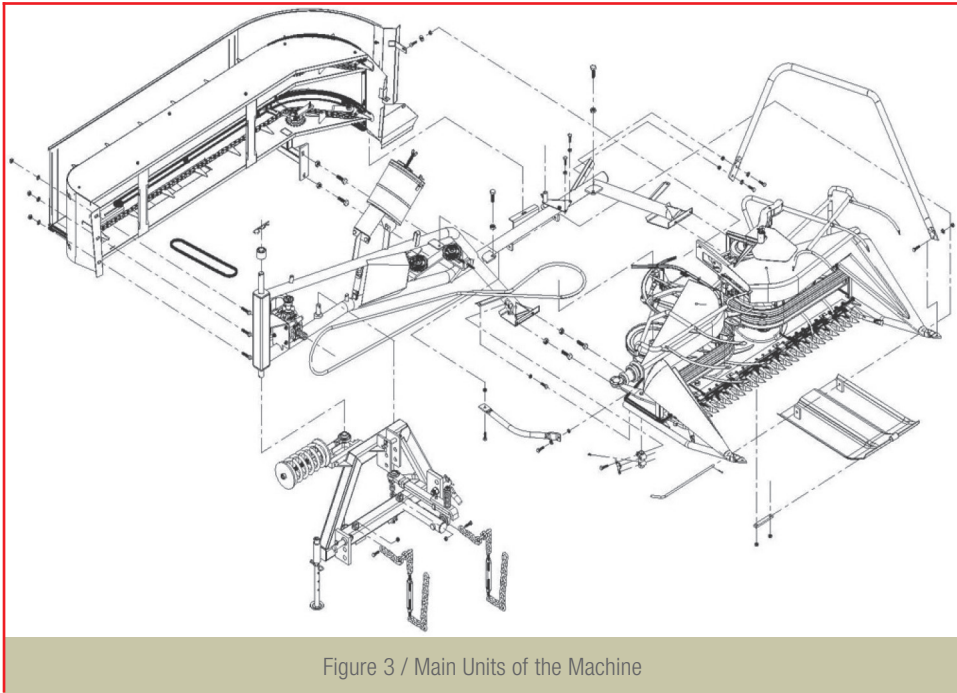

Figure 3 / Main Units of the Machine

1. Main Body
2. Three-point linkage Mechanism
3. Movement Transmission Mechanism (Transmission Box)
4. Reaping Mechanism
5. Carrier Band Group

Reaper-Binder Reaping Machine realizes following proceeding thanks to its special structure on fields where field agriculture is applied:

- This machine only does reaping and collection of crops.
- It automatically adjusts crop reaping height according to humps and holes by means of a spring.
- The reaper-binder machine is used for all crops (wheat and grained barrows, oats, ryes) grown on all kinds of fields (meadows, small hills, soft soils) within the same scope.
- It is easy to handle the machine over the roads, and transition to field system is made by 90 degrees turning left on the horizontal axis.
- Machine can be mounted on the tractor by only one person.
- In order to prevent great obstacles for the operator of the machine, it has a protection mechanism which prevents the reaping machine be damaged due to factors such as roots, pebbles and etc. and lowers the speed of impacts that would cause breaks.

Since it is power take-off driven, it provides saving from draft of tractor.

5. SETTINGS

5.1 PREPARATION AND OPERATION OF MACHINE

Mounting the machine on the tractor:

- Mount the REAPER-BINDER REAPING Machine on the tractor by means of three-point linkage mechanism. Also insert the upper and lower connection pins into the corresponding category.
- Note: Tractors having a max draft upto 40BG are expressed as Category I, and tractors having a draft between 40-100BG are expressed as Category II. Therefore, please select the diameters of upper and lower safety pins and insert them according to Category I or Category II.

The REAPER-BINDER REAPING Machine is configured according to Category II.

- See Table 1. Insert the safety pin. Adjust the upper and lower levers so as to keep the machine parallel to the ground. Meanwhile the tractor should be at a level ground.

category	Max. Draft (BG)	Lower lever tractor connection pin : hole diameter Ø (mm) (max.) - (min.)	Upper lever tractor connection pin : hole diameter Ø (mm) (max.) - (min.)
I	40	22,10-21,84	19,56-19,3
II	40-100	28,45-28,19	25,91-25,7
III	80-225	36,85-36,32	32,26-32
IV	180-400	50,8-49,7	45,5-45,2

Table-1. (Upper and lower lever connection pins required to mount the machine on the tractor and dimensions)



Operation with REAPER-BINDER MACHINE

- Maximum input revolution of a safely mounted machine is 540 rev./minute.
- Make sure that the revolution number of pto shaft of the selected tractor reaches to the number of revolutions appropriate for the machine.



ATTENTION!
ADJUST AND MAKE PREPARATIONS FOR OPERATION ONLY
WHEN THE TRACTOR IS RUNNING

5. SETTINGS

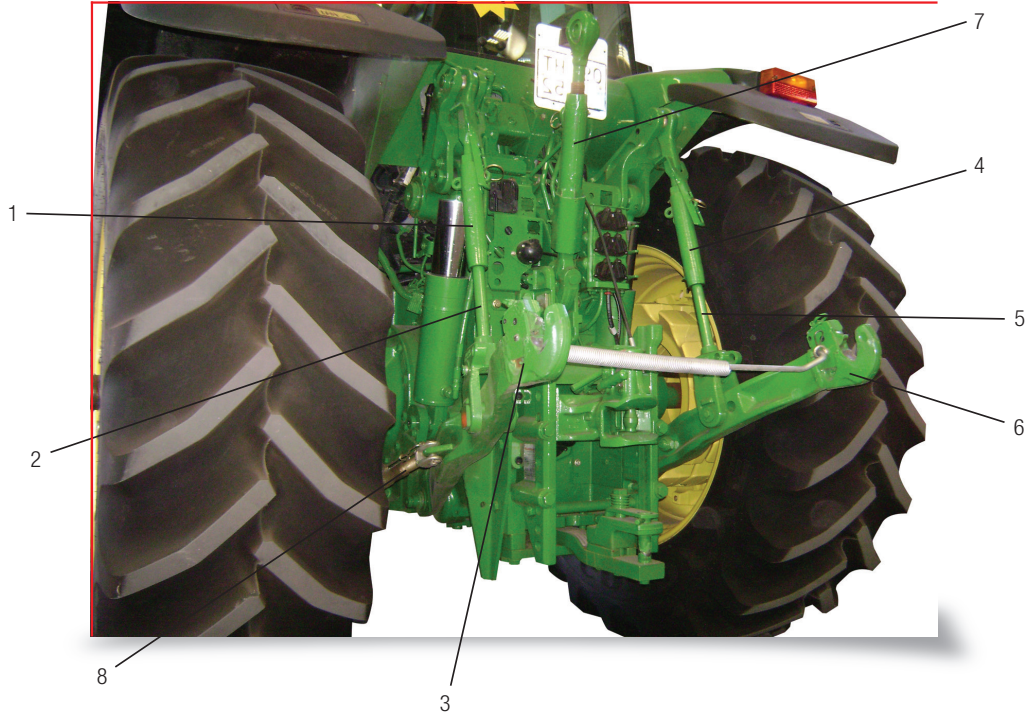

- | | |
|---|---|
| 1. Left lower link arm height adjustment mechanism | 5. Right lower link arm height adjustment lever |
| 2. Left lower link arm height adjustment lever | 6. Right lower link arm |
| 3. Left lower link arm | 7. Upper link arm (Middle arm) |
| 4. Right lower link arm height adjustment mechanism | 8. Right lower link arm tensioning mechanism |

• While mounting the machine on the tractor:

First connect the unadjusted lower connection lever, then connect the adjusted lever and finally connect the upper connection lever (middle lever). While demounting the machine do exactly reverse of this process and first demount the middle lever.

• Connection of the Shaft:

The shaft used on REAPER-BINDER REAPING Machine is ES... Shaft. The shaft used for power transmission from the tractor to agricultural tools and machinery is manufactured in an articulated and adjustable form.

- Before connecting the shaft, clean the units of pto shaft and cutter and lubricate with grease. Then slide the shaft on pto shaft until the pin exactly fits. The sliding gap of the shaft should be minimum 5 cm and maximum 15 cm. Secure the pto shaft protector with hand chain. This precaution is taken in order to prevent turn of fixed parts on the tractor and the REAPER-BINDER REAPING Machine.

- Connect and disconnect the shaft only when the ignition switch is off, engine is turned off, pto shaft is removed from the gear and the machine is seated on the ground.

- Insert the protective pipe, protective funnel of the shaft and also pto shaft and bring it to a position in compliance with the rules. If length of the shaft you use while mounting the machine on the tractor, a bending shall occur on the shaft during lifting and operation of the machine. Bring the shaft axle length into a form appropriate to the tractor in the workshop. See Figure-11

5. SETTINGS



Figure 11 / Adjusting the length of the P.T.O shaft to the proper dimension for the tractor.



ATTENTION!
**DO NOT INTERFERE THE MACHINE BY HAND,
FOOT AND FOREIGN SUBSTANCES WHILE
THE MACHINE IS RUNNING**

- Pay attention to mount the shaft is mounted safely and correctly.
- Do not let anyone in the operation area of the machine while the pto shaft is running.
- Pay attention not to let anyone stand in the environment where the turning units of shaft and pto shaft are located while the pto shaft is running.
- Do not operate the pto shaft when not required.
- Hazard with regards to operation of the machine for a little more after the pto shaft is stopped should be taken into consideration. Do not stand near the machine within this period. Approach the machine when turning movement completely stops.
- Make sure that the protective pipe case of the shaft is mounted.
- Operate REAPER - BONDER REAPING Machine only with original ALPLER shaft. ALPLER shall not be responsible for any failure arising due to use of other shafts.
- Handling the Machine to the field:

Start the tractor for about a minute. Lift the machine with the main hydraulic lever. Insert the safety lock in order to prevent damage on the hydraulic system due to shakes that may occur on the road. Stretch the stabilizer chains and avoid movement and looseness on the road.

- While on the road, lift the machine up and lock the control lever in order to prevent falling down.
- In case road pto shaft is used, it should not be forgotten that the revolution number depends on the speed of tractor; and make sure that the turning direction is not reverse during reverse movement.
- Pay attention to handling position of the machine taking tractor wheels into consideration.
- Pay attention to load status or centrifugal momentum of the machine during turning movements.
- It is dangerous to work with tractor on sloped fields. If you still have to work on sloped field despite of this danger, work carefully and make turns slowly. Make sure that the tractor is equipped with sufficient additional weight in order to assure safe movement stability and to process the sloped working field.
- Before starting work on the field:

Make the height adjustment by bringing the tractor hydraulic control lever position to control position. While in position control status, when you slightly move the hydraulic lever the machine rises up and stops at a level; if you again move the lever the machine rises more and stops; in other words the machine shall not go to the highest point as in draft control.

Note: Hydraulic up-down lever is raised up and kept at a certain level. In this case, if the tool and the machine rise up completely, then the pre selection lever is at the “DRAFT CONTROL” status. If the tool and the machine do not rise up completely and stops at a certain level, then it is at the “POSITION CONTROL” status. Position control status keeps the tool and machine connected to hydraulic connection levers at a certain height and ensures operation over the soil. While working with machinery such as centrifugal fertilizer distribution machine pre-selection lever should be at position control status.

- Operation speed of the machine shall be adjusted in accordance with lone working conditions.

TIGHTNESS OF NUTS AND BOLTS

Make sure that all nuts and bolts connecting various parts are tightened after the machine is installed. Also check this tightness before each operation.

5. SETTINGS

CONTROL OF BINDING MECHANISM

Press on the automatic ratchet and manually turn it in the direction of the arrow on the main transmission belt pulley. Continue this process until the needle returns to the point where it started movement; your binding system shall make a complete revolution. Check whether or not any negative situation or a compulsion occurs.



ATTENTION!

Press on the automatic ratchet and manually turn it in the direction of the arrow on the main transmission belt pulley. Continue this process until the needle returns to the point where it started movement; your binding system shall make a complete revolution. Check whether or not any negative situation or a compulsion occurs.

CONNECTION TO TRACTOR AND CONTROL OF PTO SHAFT

Connect the machine to tractor from three points. Prop up the pto shaft and connect one end of shaft to tractor and the other end to the machine. Start the tractor engine, and take it to idle speed. Provide low speed movement to the machine by bringing the pto shaft lever to operation position. Make sure that the main transmission pulley and collector forks are moving in the correct direction. (That's a precaution against reverse direction pto shaft movement).

6. MAINTENANCE AND REPAIR

CONNECTION OF BINDING ROPE

1. Open the cover of rope box. Take out the rope end you take from the middle of rope coil and place the coil in the box.
2. Close the rope box cover after you insert the rope end from the middle of the cover.
3. Bring ratchet providing tension over its socket on the cover and adjust tension of the rope. **Attention:** The rope should not be so tense or loose while pulling out of box.
4. After reeving the rope from two wire pools connected on the frame and the first eye in the middle of needle, reeve it from the eye at the end of needle.
5. Then, bind the rope to the shuttle frame located opposite of needle at an appropriate point.
6. Manually press on the automatic ratchet.
7. Manually turn the main transmission belt as to rotate the pulley in the direction of arrow. The needle will move towards the shuttle. Continue to turn the shuttle until the needle returns to the point where it started movement. You will see the tense rope between the needle and shuttle. Now your machine is ready for binding.
8. The size of bundles is adjusted by inserting end of automatic ratchet tension spring into appropriate holes. You can obtain the biggest bindle with fourth hole.

6. MAINTENANCE AND REPAIR

ADJUSTMENT OF BOBBIN CASE

1. If the bundles are not tied, are not knotted and thread is at the blade of pliers, control the thread by dismantling from the blade of pliers; if one end of the thread has been rent by smashing, loosen head screw as one tour, make a bundle tied again, continue this adjustment in case of levels for 1 and 1/2 tours. If one end of the thread has been cut without smashing at the pliers, tighten screw as one tour and continue adjustment like this.
2. If it is knotted and knotted thread is not gone out or hardly gone out from pliers, loosen wedge as 1 or 1/2 tour with the help of adjustable pliers.
3. If ends of threads are not cut smoothly, adjust screw No. 9 by loosening in the same table that there will be very small gap between positions of blade No. 6 and wheel No.5; if blade has become blunt, dismantle and hone it. After adjusting blade, it is not necessary to tighten screw No. 9 any longer. A light tightness is sufficient to hold blade. Otherwise you can break blade housing.
4. The reason why bundle has been formed is not only lack of adjustment of bobbin case. A knotting is passing places of thread can cause faults of tying. If thread has not been knotted anywhere, it means that diskette pressing to cap of thread box presses with much power. It is loosened butterfly nut seen in Pose 1 of Table 3 as a few tours. If thread exits more it causes that bundles become looser also.
5. If machine takes out bundles tying each other, stop the machine and remove thread wastes accumulating in the pliers. Thread cutter blade has become blunt or has been out of kilter. Dismantle, hone and adjust blade.



ATTENTION!
STOP THE MACHINE BEFORE STARTING
MAINTENANCE AND REMOVE STARTING SWITCH!

Reaper-Binder Machine was manufactured in the manner that it requires very little maintenance and repairing. It should be considered the following matters in connection with maintenance and repairing:

- Control all screws and nuts and tighten them if necessary after running for the first 5 hours and before running following.
- Make secured repairing by selecting appropriate spare parts while repairing the machine.
- Use a pair of gloves in cutting works and benefit from tools of appropriate sets in replacing running parts.
- Renew gear oils and grease oils regularly.
- Attach cables to battery and generator in electric welding works to be made in tractors and machines attaching tractors.
- Spare parts should be in accordance with the technical characteristics specified by the manufacturer firm. For that reason, consider to use original spare parts.

- Gear oil should be replaced firstly after 30 working hours and then after following 300 working hours always. Amount and quality of gear oil to be filled in are explained in the paragraph 5.1 "Technical Values" in details. Machine should be kept in hard and plain ground and in closed and dry environment. Machine should be protected against rolling and overturning dangers by placing it on chocks.

- In order to provide a high working security and work quality it is considered positions of cutting blades highly. For that reason it should be considered that blades have been tightened appropriately and have been eroded in the same adjustment before every running. Twisted blade should be replaced immediately.

CONTROL (A)	MAINTENANCE (B)			VARIATION (C)	
Maintenance Period ==>	Daily	Weekly	30 Hours	100 Hours	400 Hours
Lubrication (Control of transmission lubricant level)			A		C
Oil change (sae140)					
Oil leak control	A				
Cutter wear control	A				
Oil filling in greasers	B				
Tightness Control(nuts-bolts)	A		C		
Cleaning	B				

7. WARRANTY

While you are using your machinery, failures that you have done, against manufacturer errors, your machinery is under maintenance warranty by our company for **TWO YEARS**. Failures, which will exist because of usage errors that can be except usage forms that are determined in Handbook, are out of warranty.

Final user has no authority for attaching or repairing any part of machinery. In conditions related to failures, should apply to authorized service. Failure that are resulted by user error, are out of warranty.

Original spare parts should be used on machinery; otherwise it will be out of warranty. Interferences except for authorized services are out of warranty. In order to continue the warranty original spare part should be mounted by personnel of authorized service.

Required controls of machinery are clogging of dust sieve of aspirator bottom, heat controls of all bearing bearings (melting of grease lubricant), sound control of bearing, loosen problems of belts and reviewing of air of tyres. Machinery user should take into account safety rules besides importance of maintenance. Control whether there are alien substances in places such as bottom sieve, aspirator, tightness of screw and nut and clogging of bator sieve at work end intervals .

Machinery user should carry grease and fine lubricant can as well as for safety fire extinguisher, hand tools and assembly tools together with him.

WARRANTY CERTIFICATE

Warranted by ALPLER for a period of two years

BRAND: ALPLER

PRODUCT TYPE:

MODEL:

SERIAL NUMBER:

DATE OF PRODUCTION:

Seller's

Title:.....

Address:.....

Phone:.....

Fax:.....

Invoice Date:.....

Signature & Seal

[illegible]



Exports to 75 countries
on 5 continents.



ALPLER AGRICULTURAL MACHINERY

Umurlu Organize Sanayi Bölgesi Umurlu-AYDIN / TÜRKİYE

Tel: +90 (256) 259 1055 Fax: +90 (256) 259 1066

Web: www.alpler.com.tr E-mail: alpler@alpler.com.tr